

THIS INFORMATION IS CONFIDENTIAL AND PROPRIETARY TO HOLMARC, ITS
 WORLDWIDE SUBSIDIARIES, AND/OR AFFILIATES. IT MAY NOT BE DISCLOSED
 TO ANYONE, OTHER THAN HOLMARC PERSONNEL, WITHOUT WRITTEN
 AUTHORIZATION FROM AN AUTHORIZED REPRESENTATIVE OF HOLMARC

| REV | DESCRIPTION | DATE |
|-----|-------------|------------|
| X | X | 00/00/2018 |

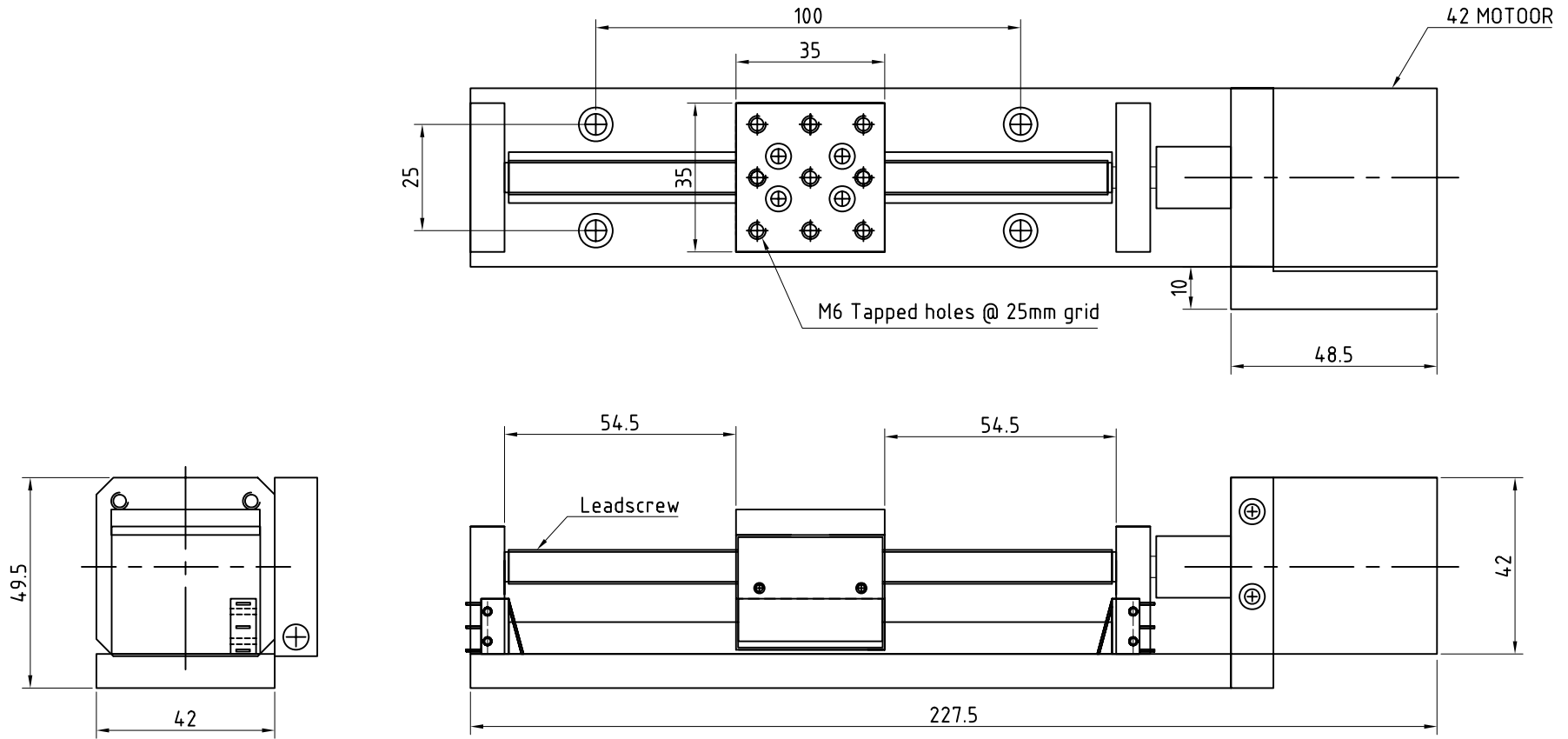

Travel - 100 mm

| GEN- Tolerances | | | | Drawn | Material | Quantity | Finish | Date | Scale | Page No. |
|-----------------|--------|--------------------|-------|----------|---|-------------|----------------|-----------------------|---------------|----------|
| Linear | | Angular | | Nithin | Aluminium-6061 | 01 no | Anodized | 20/06/20 | 1:1 | 261 |
| X | ±0.5 | X° | ±0.5° | Checked | HOLMARC OPTO-MECHATRONICS (P) Ltd | Title | | RCMTS 35-100-1 | | |
| X.X | ±0.1 | All dims are in mm | | - | | | | | | |
| X.XX | ±0.02 | | | Approved | | Part Number | Part Name | Drawing/ Model Number | Part Revision | |
| X.XXX | ±0.005 | | | Emc | 00 | Stage | RCMTS 35-100-1 | 0 | | |